

Power Divider/Combiners, 7-16

DrawCom introduces a compact, 100 watt, Wilkinson power combiner/divider series ideally designed for systems applications utilizing multiple high-power transmitter or antenna feeds. Standard models are available in 2-way and 4-way configurations for all wireless bands between 0.800 and 2.200 GHz. Your applications will benefit from high isolation, low insertion loss and exceptional VSWR. Mechanical features include a rugged aluminium housing specially designed to provide excellent heat transfer for applications where additional heatsink is required. Weatherproof models (IP65) available.

DrawCom also offers a new line of compact, high-power capable (200 watts) reactive RF splitters covering all wireless frequencies from 0.800 - 2.700 GHz. Available in 2-way and 3-way configurations. This reactive RF splitter series provides a low loss, equal power split at all output ports while maintaining excellent amplitude and phase balance.

Theoretical power split (dB) for "n-way" power divider

2-Way	3-Way	4-Way	6-Way	8-Way	9-Way	12-Way	16-Way
3.01	4.77	6.02	7.78	9.03	9.54	10.79	12.04

Selection Guide

Part No.	Freq. (GHz)	Isolation (dB)		Insertion Loss (dB)		Amplitude Balance (dB) (Max)	Phase Balance (degrees) (Max)	VSWR			
		Typ	Min	Typ	Max			Input		Output	
								Typ	Max	Typ	Max
7/16 DIN Power Combiner Models, 100 Watts											
H2D-0.460	0.40-0.52	22	20	0.20	0.25	0.1	2	1.15:1	1.20:1	1.15:1	1.20:1
H2D-0.900	0.8-1.0	25	20	0.20	0.25	0.1	2	1.20:1	1.25:1	1.10:1	1.15:1
H2D-1.500V	0.8-2.2	20	18	0.40	0.60	0.3	3	1.30:1	1.40:1	1.15:1	1.20:1
H2D-1.950	1.7-2.2	25	20	0.25	0.30	0.1	2	1.25:1	1.30:1	1.15:1	1.20:1
H4D-0.900	0.8-1.0	25	20	0.30	0.40	0.2	2	1.20:1	1.25:1	1.10:1	1.15:1
H4D-1.500V	0.8-2.2	20	18	1.00	1.20	0.3	4	1.40:1	1.50:1	1.20:1	1.30:1
7/16 DIN Power Splitters, 200 Watts											
R2D-1.900-M01	0.8-2.7	~	~	0.30	0.40	0.2	2	1.10:1	1.20:1	~	~
R3D-1.900-M01	0.8-2.7	~	~	0.30	0.40	0.2	2	1.20:1	1.30:1	~	~

Note: The power ratings in this datasheet are nominal average power in the forward direction. DrawCom can supply detailed forward and reverse power specification data on request.



Power Divider/Combiners, 7-16 (cont.)



A wide range of splitters are available for power splitting or providing multiple receiver outputs. Most combinations of split can be catered for i.e. 2, 3, & 4 Way. Splitters may also be used in reverse as combiners provided that the power rating of the internal loads is not exceeded. DrawCom splitters are housed in milled aluminium cases that can be sealed to IP65 for external use.

- Low loss
- Good balance
- Wide bandwidth available
- Isolated outputs
- Suitable for low power combining

Selection Guide

Part No.	No. Outputs	Freq. Range (MHz)	Insertion Loss (dB)	Return Loss all ports (dB)	Isolation (dB)	Splitter Power Rating (W)	Combiner Power Rating (W)	Temp. Range (°C)	RF Conns	Dimensions (mm)	Enviro
07-007901	2-way	800-2500	<3.5	≥ 15.6	≥ 18	200	30	-20 to +60	7-16 Female	112x53x36	IP 65
05-009701	2-way	68-650	<3.5	>15	≥ 17	100	50 #	-20 to +55	7-16 Female	203x178x51	IP 65
05-003206	2-way	380-430	<3.5	≥ 18	≥ 18	100		-20 to +60	7-16 Female	100x68x40	IP 65
05-009801	2-way	15-960 / 1700-2700	≤ 3.5 / ≤ 4.6	≥ 13	≥ 15	100		-20 to +55	7-16 Female	232x103x50	IP 65
05-009502	2-way	68-470	<3.4	≥ 19	≥ 19	100		-20 to +55	7-16 Female	203x178x51	IP 65
07-011401	3-way	800-2300	<5.5	>15	>15	200	30	-20 to +60	7-16 Female	138x45x36	IP 65
05-006001	4-way	800- 500	<7.0	>15	>15	200	30	-20 to +60	7-16 Female	138x92x36	IP 65

#100W with additional heatsink

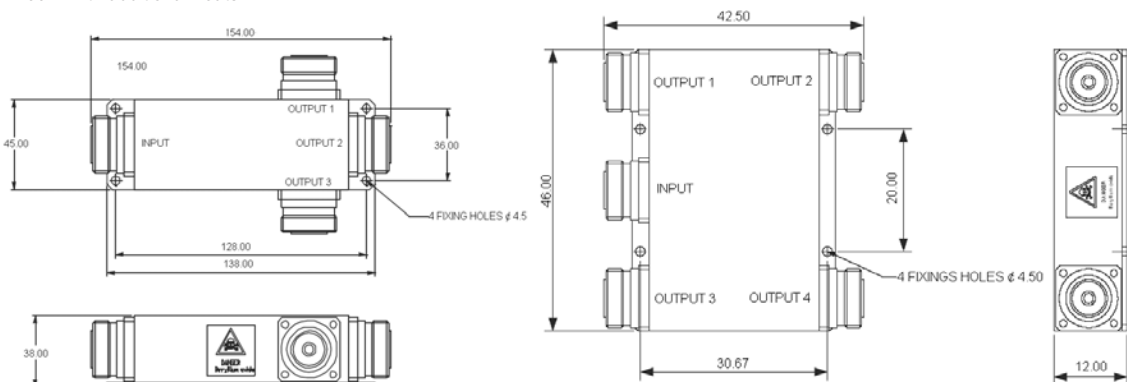

DrawCom Pty Ltd

Page 45

Power Divider/Combiners, N



A wide range of splitters are available for power splitting or providing multiple receiver outputs. Most combinations of split can be catered for i.e. 2, 3, & 4 Way. Splitters may also be used in reverse as combiners provided that the power rating of the internal loads are not exceeded. DrawCom splitters are housed in milled aluminium cases that can be sealed to IP65 for external use.

- Low loss
- Good balance
- Wide bandwidth available
- Isolated outputs
- Suitable for low power combining

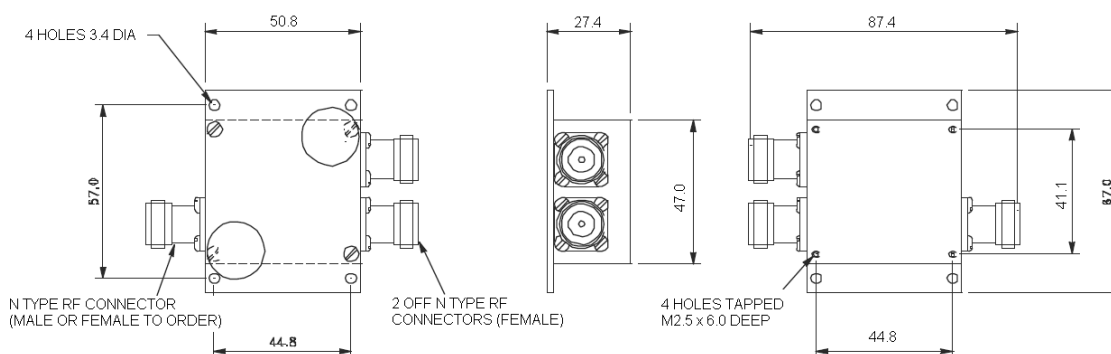

07-002502

Selection Guide: 2-Way Splitters

Part No.	Frequency Range (MHz)	Insertion Loss (dB)	Return Loss all ports (dB)	Isolation (dB)	Splitter Power Rating (W)	Combiner Power Rating (W)	Temp. Range (°C)	RF Conns	Dimensions (mm)	Enviro
05-005501	800 - 2500	< 3.5	≥ 15.6	≥ 18	200	10	-20 to +60	Type-N Female	110x53x23	IP 65
05-003017	380 - 470	<3.5	≥ 17.7	≥ 18	50	10	-20 to +55	Type-N Female	70x63x21	IP 65
05-009802	15-960 / 1700-2700	≤ 3.5 / ≤ 4.6	≥ 13	≥ 15	100		-20 to +55	Type-N Female	232x103x50	IP 65
07-002502	50-500	≤ 3.5	≥ 18	≥ 18	1		-20 to +60	Type-N Female	287.5x51x27.5	IP 55
05-009501	68 - 470	< 3.4	≥ 18	≥ 19	100		-20 to +55	Type-N Female	203x178.5x24	IP 65

Power Divider/Combiners, N (cont.)

Selection Guide: 2-Way Splitters

Part No.	No. Outputs	Freq Range (MHz)	Insertion Loss (dB)	Return Loss all ports (dB)	Isolation (dB)	Splitter Power Rating (W)	Total Combiner Power Rating (W)	Temp. Range (°C)	RF Conns	Dimensions (mm)	Enviro
07-011501	3-way	800 - 2300	< 5.5	15.6	> 15	200	30	-20 to +60	Type-N Female	138x45x25	IP 65
07-005401	3-way	160 - 470	< 5.2	17.7	> 18	200	30	-20 to +60	Type-N Female		IP 65
05-006101	4-way	800 - 2500	< 7.0	15.6	> 15	200	30	-20 to +60	Type-N Female	138x92x25	IP 65

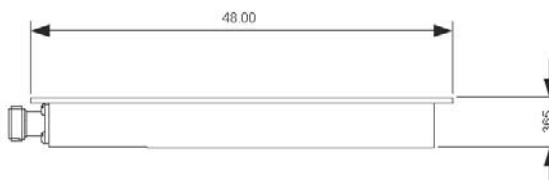
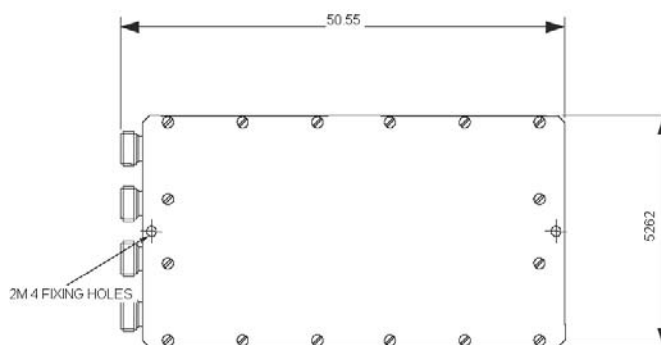

07-005401

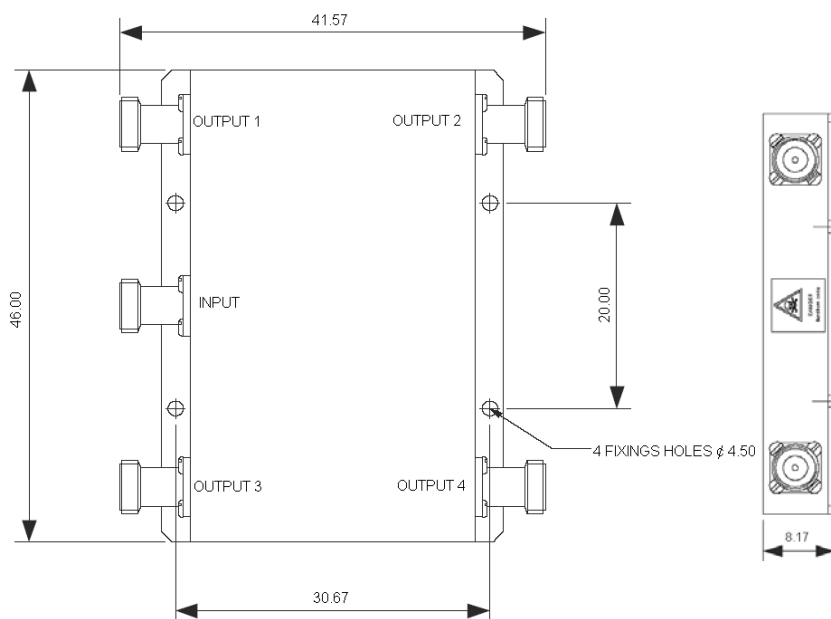

05-006101

Print Date: 29/05/2009

All information contained in the present data sheet is subject to confirmation at time of ordering.

Coax Components

Power Divider/Combiners, N (cont.)



DrawCom offers a broad range of 2-way splitters with type-N connectors including...

- **20 watt Divider/Combiners:** Compact microstrip power divider/combiners delivering high isolation, minimal insertion loss and exceptional phase and amplitude balance.
- **“Tee” Configuration:** Allows unobstructed access to all connector ports. Covering all wireless bands from 0.8 - 3.0 GHz, 2.4 GHz and 5.8 GHz. Ideal for in-building wireless systems.
- **DC Blocking:** Constructed with DC blocking capacitors on all ports except those that are intended to pass DC.
- **M-Series:** 50-watt, Wilkinson series ideally suited for 0.8 to 2.2 GHz to extend system coverage.
- **H-Series:** 100 watt, Wilkinson series ideally designed for systems applications.
- **Reactive Splitters:** High-power capable (200 watts) covering all wireless frequencies from 0.800 - 2.700 GHz.

Theoretical power split (dB) for "n-way" power divider

2-Way	3-Way	4-Way	6-Way	8-Way	9-Way	12-Way	16-Way
3.01	4.77	6.02	7.78	9.03	9.54	10.79	12.04

Selection Guide

Part No.	Freq. (GHz)	Isolation (dB)		Insertion Loss (dB)		Amplitude Balance (dB) (Max)	Phase Balance (degrees) (Max)	VSWR			
		Typ	Min	Typ	Max			Input		Output	
								Typ	Max	Typ	Max
2-Way 20 Watt Power Dividers											
802-4-0.600	0.4-0.8	27	22	0.20	0.30	0.1	2	1.15:1	1.20:1	1.10:1	1.15:1
802-4-0.750	0.5-1.0	25	22	0.20	0.30	0.1	2	1.15:1	1.20:1	1.10:1	1.15:1
802-4-0.900	0.8-1.0	40	30	0.20	0.25	0.1	1	1.10:1	1.15:1	1.10:1	1.15:1
	0.6-1.2	25	20	0.20	0.30	0.1	2	1.20:1	1.25:1	1.10:1	1.15:1
802-4-1.500	1.0-2.0	25	22	0.20	0.30	0.1	2	1.15:1	1.20:1	1.10:1	1.15:1
802-4-1.500V	0.8-2.2	27	22	0.30	0.40	0.1	2	1.15:1	1.25:1	1.10:1	1.20:1
802-4-1.900	0.8-3.0	27	22	0.40	0.50	0.2	3	1.10:1	1.20:1	1.10:1	1.20:1
802-4-1.950	1.7-2.2	40	30	0.20	0.25	0.1	1	1.10:1	1.15:1	1.10:1	1.15:1
	1.3-2.7	25	20	0.30	0.40	0.1	2	1.20:1	1.30:1	1.10:1	1.15:1
802-4-2.400	2.1-2.7	40	30	0.20	25	0.1	1	1.10:1	1.15:1	1.10:1	1.15:1
	1.6-3.2	50	20	0.20	0.30	0.1	2	1.20:1	1.25:1	1.10:1	1.15:1
802-4-3.100	2.0-4.2	25	22	0.30	0.40	0.1	3	1.20:1	1.30:1	1.10:1	1.20:1
2-Way 20 Watt "Tee" Power Dividers											
P2N-1.900V	0.8-3.0	25	22	0.40	0.50	0.2	3	1.15:1	1.30:1	1.10:1	1.20:1
P2N-2.450	2.4-2.5	27	22	0.20	0.30	0.1	2	1.15:1	1.15:1	1.10:1	1.10:1
P2N-5.500	5.0-6.0	25	20	0.20	0.30	0.1	2	1.20:1	1.25:1	1.15:1	1.20:1
2-Way 20 Watt DC Block Power Dividers											
DC802-4-1.500V	0.8-2.2	27	22	0.30	0.40	0.1	2	1.15:1	1.25:1	1.10:1	1.20:1

Power Divider/Combiners, N (cont.)

Part No.	Freq. (GHz)	Selection Guide									
		Isolation (dB)		Insertion Loss (dB)		Amplitude Balance (dB) (Max)	Phase Balance (degrees) (Max)	VSWR			
		Typ	Min	Typ	Max			Input		Output	
								Typ	Max	Typ	Max
2-Way 50 Watt M-Series Power Dividers											
M2N-1.500W	0.8-2.2	27	22	0.30	0.40	0.1	2	1.15:1	1.25:1	1.10:1	1.20:1
2-Way 80 Watt H-Series Power Dividers											
H2N-0.460	0.40-0.52	22	20	0.20	0.25	0.1	2	1.15:1	1.20:1	1.15:1	1.20:1
H2N-0.900	0.8-1.0	25	20	0.20	0.25	0.1	2	1.20:1	1.25:1	1.10:1	1.15:1
H2N-1.500V	0.8-2.2	25	15	0.40	0.60	0.3	3	1.30:1	1.40:1	1.15:1	1.25:1
H2N-1.950	1.7-2.2	25	20	0.25	0.30	0.1	2	1.25:1	1.30:1	1.15:1	1.20:1
2-Way 200 Watt Reactive RF Splitters											
R2N-1.900-M01	0.8-2.7	~	~	0.30	0.40	0.2	2	1.10:1	1.20:1	~	~
3-Way 20 Watt Power Dividers											
803-4-0.600	0.4-0.8	27	22	0.30	0.40	0.2	3	1.20:1	1.25:1	1.10:1	1.15:1
803-4-0.900	0.8-1.0	40	30	0.30	0.40	0.2	3	1.10:1	1.15:1	1.10:1	1.15:1
	0.6-1.2	25	20	0.30	0.40	0.2	3	1.25:1	1.35:1	1.10:1	1.20:1
803-4-1.500V	0.8-2.2	30	25	0.40	0.60	0.2	4	1.20:1	1.30:1	1.15:1	1.25:1
803-4-1.900	0.8-3.0	27	22	0.60	0.80	0.4	6	1.20:1	1.30:1	1.10:1	1.20:1
803-4-2.100	1.5-2.7	35	30	0.35	0.45	0.2	3	1.15:1	1.20:1	1.10:1	1.15:1
803-4-3.000	2.0-4.0	25	22	0.40	0.50	0.2	4	1.25:1	1.35:1	1.10:1	1.20:1
3-Way 20 Watt "Tee" Power Dividers											
P3N-1.900V	0.8-3.0	22	18	0.60	0.80	0.4	6	1.15:1	1.35:1	1.10:1	1.30:1
P3N-2.450	2.4-2.5	22	18	0.20	0.30	0.2	3	1.15:1	1.25:1	1.10:1	1.30:1
P3N-5.500	5.0-6.0	22	18	0.40	0.50	0.2	4	1.20:1	1.25:1	1.20:1	1.25:1
3-Way 20 Watt DC Block Power Dividers											
DC803-4-1.500V	0.8-2.2	20	17	0.50	0.60	0.2	4	1.40:1	1.50:1	1.20:1	1.30:1
3-Way 80 Watt H-Series Power Dividers											
H3N-0.900	0.8-1.0	27	22	0.30	0.40	0.2	4	1.10:1	1.20:1	1.10:1	1.15:1
H3N-1.950	1.7-2.2	20	18	0.60	0.70	0.2	4	1.25:1	1.45:1	1.25:1	1.35:1
3-Way 200 Watt Reactive RF Splitters											
R3N-1.900-M01	0.8-2.7	~	~	0.30	0.40	0.2	2	1.20:1	1.30:1	~	~

Power Divider/Combiners, N (cont.)

Selection Guide											
Part No.	Freq. (GHz)	Isolation (dB)		Insertion Loss (dB)		Amplitude Balance (dB) (Max)	Phase Balance (degrees) (Max)	VSWR			
		Typ	Min	Typ	Max			Input		Output	
								Typ	Max	Typ	Max
4-Way 20 Watt Power Dividers											
804-4-0.600	0.4-0.8	25	20	0.60	0.80	0.2	4	1.20:1	1.30:1	1.10:1	1.20:1
804-4-0.900	0.8-1.0	35	30	0.50	0.60	0.2	3	1.15:1	1.20:1	1.10:1	1.15:1
	0.6-1.2	25	20	0.60	0.70	0.2	4	1.40:1	1.50:1	1.10:1	1.15:1
804-4-1.500V	0.8-2.2	27	22	0.60	0.80	0.2	4	1.25:1	1.35:1	1.15:1	1.25:1
804-4-1.900	0.8-3.0	25	20	0.80	1.00	0.2	4	1.25:1	1.35:1	1.15:1	1.25:1
	1.7-2.2	23	27	0.50	0.60	0.2	3	1.15:1	1.20:1	1.10:1	1.15:1
804-4-1.950	1.3-2.6	20	15	0.70	0.90	0.2	4	1.20:1	1.30:1	1.10:1	1.20:1
	1.5-2.7	32	27	0.50	0.60	0.2	3	1.15:1	1.20:1	1.10:1	1.15:1
804-4-3.000	2.0-4.0	25	20	0.60	0.80	0.2	4	1.25:1	1.35:1	1.15:1	1.25:1
4-Way 20 Watt DC Block Power Dividers											
DC804-4-1.500V	0.8-2.2	25	20	0.60	0.80	0.2	4	1.25:1	1.35:1	1.15:1	1.25:1
4-Way 50 Watt M-Series Power Dividers											
M4N-1.500W	0.8-2.2	25	20	0.60	0.80	0.2	4	1.25:1	1.35:1	1.15:1	1.25:1
4-Way 80 Watt H-Series Power Dividers											
H4N-0.900	0.8-1.0	25	20	0.30	0.40	0.2	2	1.20:1	1.25:1	1.10:1	1.15:1
H4N-1.500V	0.8-2.2	20	18	1.00	1.20	0.3	4	1.40:1	1.50:1	1.20:1	1.30:1
H4N-1.950	1.7-2.2	23	18	0.40	0.50	0.2	4	1.20:1	1.30:1	1.10:1	1.20:1
6-Way 20 Watt Power Dividers											
806-4-0.900	0.8-1.0	35	30	0.40	0.50	0.2	3	1.15:1	1.20:1	1.10:1	1.15:1
	0.6-1.2	22	17	0.50	0.70	0.2	3	1.40:1	1.50:1	1.25:1	1.35:1
806-4-1.500V	0.8-2.2	30	25	0.60	0.80	0.2	6	1.25:1	1.35:1	1.10:1	1.20:1
806-4-1.900	0.8-3.0	25	20	0.80	1.20	0.4	8	1.30:1	1.45:1	1.20:1	1.35:1
806-4-2.100	1.5-2.7	30	25	0.60	0.70	0.2	3	1.30:1	1.40:1	1.10:1	1.20:1
806-4-3.100	2.0-4.2	25	20	0.60	0.80	0.3	4	1.35:1	1.45:1	1.15:1	1.25:1
8-Way 20 Watt Power Dividers											
808-4-0.900	0.8-1.0	32	27	0.80	1.00	0.2	3	1.20:1	1.25:1	1.10:1	1.15:1
808-4-1.500V	0.8-2.2	27	22	0.80	1.20	0.2	8	1.25:1	1.35:1	1.10:1	1.20:1
808-4-1.900	0.8-3.0	25	20	1.00	1.40	0.3	8	1.30:1	1.40:1	1.15:1	1.25:1
808-4-2.100	1.5-2.7	30	25	0.80	0.90	0.2	4	1.15:1	1.20:1	1.10:1	1.15:1
808-4-3.100	2.0-4.2	27	22	0.80	1.00	0.2	4	1.30:1	1.40:1	1.15:1	1.25:1
8-Way 50 Watt M-Series Power Dividers											
M8N-1.500W	0.8-2.2	27	22	0.80	1.20	0.2	8	1.25:1	1.35:1	1.10:1	1.20:1
9-Way 20 Watt Power Dividers											
804-4-0.900	0.8-1.0	35	30	0.80	1.00	0.3	4	1.15:1	1.20:1	1.10:1	1.15:1
	0.6-1.2	25	20	0.80	1.20	0.3	4	1.45:1	1.55:1	1.10:1	1.15:1
809-4-1.500V	0.8-2.2	20	17	1.000	1.20	0.3	8	1.30:1	1.40:1	1.20:1	1.30:1
809-4-1.900	0.8-3.0	25	20	1.40	1.80	0.3	10	1.30:1	1.40:1	1.10:1	1.20:1
809-4-2.100	1.5-2.7	30	25	1.00	1.20	0.3	8	1.25:1	1.40:1	1.10:1	1.20:1
809-4-3.100	2.0-4.2	25	22	0.90	1.30	0.3	8	1.35:1	1.45:1	1.15:1	1.25:1

Power Divider/Combiners, N (cont.)

Selection Guide											
Part No.	Freq. (GHz)	Isolation (dB)		Insertion Loss (dB)		Amplitude Balance (dB) (Max)	Phase Balance (degrees) (Max)	VSWR			
		Typ	Min	Typ	Max			Input		Output	
								Typ	Max	Typ	Max
12-Way 20 Watt Power Dividers											
812-4-0.900	0.8-1.0	40	30	0.80	1.00	0.3	6	1.10:1	1.15:1	1.10:1	1.15:1
812-4-1.500V	0.8-2.2	30	25	1.00	1.20	0.3	8	1.30:1	1.40:1	1.15:1	1.25:1
812-4-1.900	0.8-3.0	25	20	1.00	1.50	0.4	10	1.30:1	1.45:1	1.20:1	1.35:1
812-4-2.100	1.5-2.7	30	22	0.80	1.00	0.3	6	1.30:1	1.40:1	1.10:1	1.20:1
812-4-3.100	2.0-4.2	25	22	1.00	1.20	0.3	8	1.30:1	1.40:1	1.15:1	1.25:1
16-Way 20 Watt Power Dividers											
816-4-0.900	0.8-1.0	32	27	1.20	1.30	0.2	8	1.10:1	1.15:1	1.10:1	1.15:1
816-4-1.500V	0.8-2.2	25	20	1.20	1.60	0.4	10	1.30:1	1.40:1	1.10:1	1.20:1
816-4-1.900	0.8-3.0	25	20	1.50	1.60	0.5	12	1.40:1	1.50:1	1.15:1	1.25:1
816-4-2.100	1.5-2.7	30	25	1.60	1.70	0.4	8	1.25:1	1.35:1	1.10:1	1.20:1
816-4-3.100	2.0-4.2	25	22	1.60	1.80	0.4	10	1.20:1	1.30:1	1.15:1	1.25:1

Note: The power ratings in this datasheet are nominal average power in the forward direction. DrawCom can supply more data on request that contains detailed forward and reverse power specifications.

Power Divider/Combiners, TNC

DrawCom offers 4 models of TNC-Female power divider/combiners, each with a frequency range of 0.800 - 2.200 GHz. The range includes 2-way, 4-way, 6-way and 8-way configurations. The power rating is 20 Watts average.

Theoretical power split (dB) for "n-way" power divider							
2-Way	3-Way	4-Way	6-Way	8-Way	9-Way	12-Way	16-Way
3.01	4.77	6.02	7.78	9.03	9.54	10.79	12.04



Selection Guide

Part No.	Freq. (GHz)	Isolation (dB)		Insertion Loss (dB)		Amplitude Balance (dB) (Max)	Phase Balance (degrees) (Max)	VSWR			
		Typ	Min	Typ	Max			Input		Output	
								Typ	Max	Typ	Max
802-6-1.500V	0.8-2.2	27	22	0.3	0.4	0.1	2	1.15:1	1.25:1	1.10:1	1.20:1
804-6-1.500V	0.8-2.2	25	20	0.6	0.8	0.2	4	1.25:1	1.35:1	1.15:1	1.25:1
806-6-1.500V	0.8-2.2	30	25	0.6	0.8	0.2	6	1.25:1	1.35:1	1.10:1	1.20:1
808-6-1.500V	0.8-2.2	27	22	0.8	1.20	0.2	8	1.25:1	1.35:1	1.10:1	1.20:1

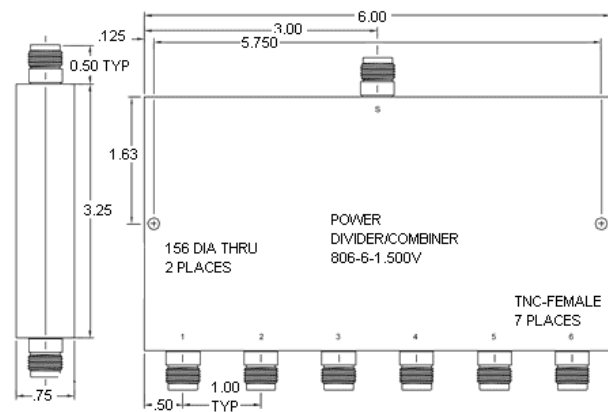
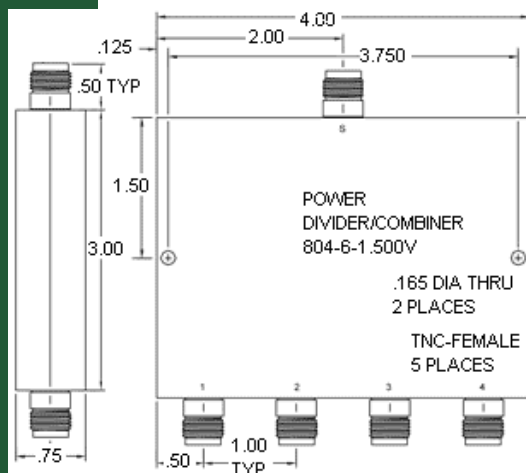
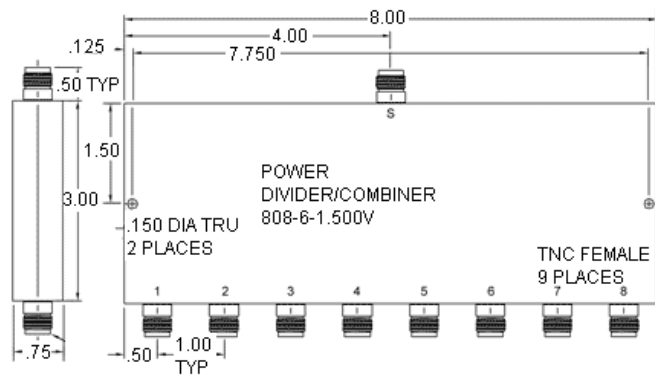
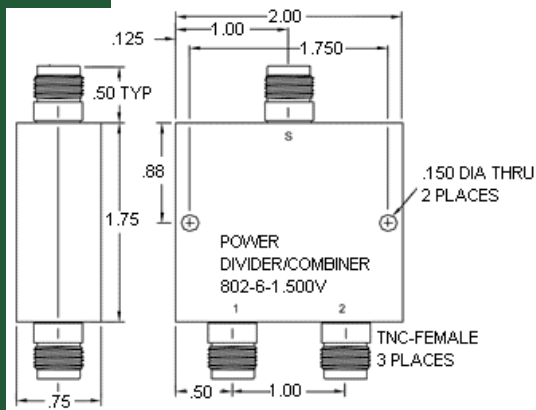

Power Divider/Combiners, SMA



DrawCom offers a broad range of 2-way splitters with SMA connectors including...

- **20 watt Divider/Combiners:** Compact microstrip power divider/combiners delivering high isolation, minimal insertion loss and exceptional phase and amplitude balance.
- **“Tee” Configuration:** Allows unobstructed access to all connector ports. Covering all wireless bands from 0.8 - 3.0 GHz, 2.4 GHz and 5.8 GHz. Ideal for in-building wireless systems.
- **DC Blocking:** Constructed with DC blocking capacitors on all ports except those that are intended to pass DC.
- **M-Series:** 50-Watt, Wilkinson series ideally suited for 0.8 to 2.2 GHz to extend system coverage.
- **H-Series:** 80 Watt, Wilkinson series ideally designed for systems applications.
- **Reactive Splitters:** High-power capable (200 watts) covering all wireless frequencies from 0.800 - 2.700 GHz.

Theoretical power split (dB) for "n-way" power divider

2-Way	3-Way	4-Way	6-Way	8-Way	9-Way	12-Way	16-Way
3.01	4.77	6.02	7.78	9.03	9.54	10.79	12.04

Selection Guide

Part No.	Freq. (GHz)	Isolation (dB)		Insertion Loss (dB)		Amplitude Balance (dB) (Max)	Phase Balance (degrees) (Max)	VSWR			
		Typ	Min	Typ	Max			Input		Output	
								Typ	Max	Typ	Max
2-Way 20 Watt Power Dividers											
802-2-0.600-M01	0.4-0.8	27	22	0.20	0.30	0.1	2	1.15:1	1.20:1	1.10:1	1.15:1
802-2-0.900	0.8-1.0	40	30	0.20	0.25	0.1	1	1.10:1	1.15:1	1.10:1	1.15:1
	0.6-1.2	25	20	0.20	0.30	0.1	2	1.15:1	1.25:1	1.10:1	1.15:1
802-2-1.500V	0.8-2.2	27	22	0.30	0.40	0.1	2	1.15:1	1.25:1	1.10:1	1.20:1
802-S-1.900-M01	0.8-3.0	27	22	0.40	0.50	0.2	3	1.10:1	1.20:1	1.10:1	1.20:1
802-2-1.950	1.7-2.2	40	30	0.20	0.25	0.1	1	1.10:1	1.15:1	1.10:1	1.15:1
	1.3-2.6	25	20	0.25	0.35	0.1	2	1.30:1	1.40:1	1.10:1	1.20:1
802-2-2.100	1.5-2.7	30	25	0.20	0.30	0.1	2	1.15:1	1.25:1	1.10:1	1.20:1
802-2-2.500	1.0-4.0	25	20	0.40	0.50	0.2	2	1.25:1	1.35:1	1.15:1	1.25:1
802-2-3.000	2.0-4.0	25	22	0.20	0.30	0.1	2	1.15:1	1.25:1	1.10:1	1.15:1
802-2-6.000	4.0-8.0	22	20	0.20	0.30	0.2	4	1.20:1	1.30:1	1.15:1	1.25:1
802-2-9.700	7.0-12.4	21	19	0.40	0.50	0.2	4	1.30:1	1.40:1	1.25:1	1.35:1
802-2-10.000	2.0-18.0	19	17	~	1.00	0.3	5	1.50:1	~	1.50:1	~
802-2-15.000	12.0-18.0	20	18	0.50	0.60	0.3	6	1.30:1	1.40:1	1.25:1	1.35:1
802-2-11.500-M01	4.0-18.0	20	18	0.40	0.50	0.3	6	1.30:1	1.40:1	1.25:1	1.35:1
2-Way 20 Watt "Tee" Power Dividers											
P2S-1.900V	0.8-3.0	27	22	0.20	0.30	0.1	2	1.15:1	1.20:1	1.10:1	1.15:1
P2S-2.450	2.4-2.5	25	22	0.20	0.30	0.1	2	1.15:1	1.20:1	1.10:1	1.15:1
P2S-5.500	5.0-6.0	25	20	0.20	0.30	0.1	2	1.20:1	1.15:1	1.15:1	1.20:1

Power Divider/Combiners, SMA (cont.)



Selection Guide

Part No.	Freq. (GHz)	Isolation (dB)		Insertion Loss (dB)		Amplitude Balance (dB) (Max)	Phase Balance (degrees) (Max)	VSWR			
		Typ	Min	Typ	Max			Input		Output	
								Typ	Max	Typ	Max
2-Way 20 Watt DC Block Power Dividers											
DC802-2-1.500V	0.8-2.2	27	22	0.30	0.40	0.1	2	1.15:1	1.25:1	1.10:1	1.20:1
2-Way 50 Watt M-Series Power Dividers											
M2S-1.500W	0.8-2.2	27	22	0.30	0.40	0.1	2	1.15:1	1.25:1	1.10:1	1.20:1
2-Way 80 Watt H-Series Power Dividers											
H2S-0.460	0.40-0.52	22	20	0.20	0.25	0.1	2	1.15:1	1.20:1	1.15:1	1.20:1
H2S-0.900	0.8-1.0	25	20	0.20	0.30	0.1	2	1.20:1	1.25:1	1.10:1	1.15:1
H2S-1.500V	0.8-2.2	20	18	0.40	0.60	0.3	3	1.30:1	1.40:1	1.15:1	1.20:1
H2S-1.950	1.7-2.2	25	20	0.25	0.30	0.1	2	1.25:1	1.30:1	1.15:1	1.20:1
2-Way 200 Watt Reactive RF Splitters											
R2S-1.900-M01	0.8-2.7	~	~	0.30	0.40	0.2	2	1.10:1	1.20:1	~	~
3-Way 20 Watt Power Dividers											
803-2-0.600-M01	0.4-0.8	27	22	0.20	0.30	0.2	3	1.20:1	1.30:1	1.10:1	1.15:1
803-2-0.900	0.8-1.0	40	30	0.30	0.35	0.2	3	1.10:1	1.15:1	1.10:1	1.15:1
	0.6-1.2	25	20	0.30	0.40	0.2	3	1.35:1	1.45:1	1.10:1	1.15:1
803-2-1.500V	0.8-2.2	30	25	0.40	0.60	0.2	4	1.20:1	1.30:1	1.15:1	1.25:1
803-S-1.900-M01	0.8-3.0	27	22	0.60	0.80	0.4	6	1.20:1	1.30:1	1.10:1	1.20:1
803-2-1.950	1.7-2.2	35	30	0.35	0.40	0.2	3	1.15:1	1.20:1	1.15:1	1.20:1
803-2-2.100	1.5-2.7	30	25	0.40	0.50	0.2	3	1.20:1	1.30:1	1.10:1	1.20:1
803-2-3.000	2.0-4.0	25	22	0.50	0.60	0.3	4	1.30:1	1.40:1	1.20:1	1.30:1
3-Way 20 Watt "Tee" Power Dividers											
P3S-1.900V	0.8-3.0	22	18	0.60	0.80	0.4	6	1.25:1	1.35:1	1.20:1	1.30:1
P3S-2.450	2.4-2.5	22	18	0.20	0.30	0.2	3	1.15:1	1.25:1	1.10:1	1.30:1
P3S-5.500	5.0-6.0	22	18	0.40	0.50	0.2	3	1.20:1	1.25:1	1.20:1	1.25:1
3-Way 20 Watt DC Block Power Dividers											
DC803-2-1.500V	0.8-2.2	30	25	0.40	0.60	0.2	4	1.20:1	1.30:1	1.15:1	1.25:1
3-Way 80 Watt H-Series Power Dividers											
H3S-0.900	0.8-1.0	27	22	0.30	0.40	0.2	4	1.10:1	1.20:1	1.10:1	1.15:1
H3S-1.950	1.7-2.2	20	18	0.60	0.70	0.2	4	1.25:1	1.45:1	1.25:1	1.35:1
3-Way 200 Watt Reactive RF Splitters											
R3S-1.900-M01	0.8-2.7	~	~	0.30	0.40	0.2	3	1.20:1	1.30:1	~	~
4-Way 20 Watt Power Dividers											
804-2-0.600-M01	0.4-0.8	25	20	0.60	0.80	0.2	4	1.20:1	1.30:1	1.10:1	1.20:1
804-2-0.900	0.8-1.0	35	30	0.40	0.50	0.2	3	1.15:1	1.20:1	1.05:1	1.10:1
	0.6-1.2	22	18	0.60	0.80	0.2	3	1.40:1	1.60:1	1.10:1	1.15:1
804-2-1.500	0.8-2.2	27	22	0.60	0.80	0.2	4	1.20:1	1.30:1	1.10:1	1.20:1
804-S-1.900-M01	0.8-3.0	25	20	0.80	1.00	0.2	4	1.25:1	1.35:1	1.15:1	1.25:1
804-2-2.100	1.5-2.7	30	25	0.50	0.60	0.2	4	1.20:1	1.30:1	1.10:1	1.20:1
804-2-3.000	2.0-4.0	25	20	0.50	0.70	0.2	4	1.20:1	1.30:1	1.10:1	1.15:1
804-2-6.000	4.0-8.0	22	20	0.40	0.50	0.3	4	1.40:1	1.45:1	1.25:1	1.30:1
804-2-9.700	7.0-12.4	20	19	0.70	0.80	0.4	5	1.50:1	1.55:1	1.30:1	1.40:1
804-2-10.000	2.0-18.0	17	15	1.80	2.00	0.6	6	1.50:1	1.60:1	1.40:1	1.50:1
804-2-10.500-M01	5.0-16.0	20	18	0.80	1.00	0.4	5	1.50:1	1.55:1	1.30:1	1.40:1
804-2-11.500-M01	4.0-18.0	20	18	0.80	1.00	0.5	5	1.50:1	1.55:1	1.30:1	1.40:1
804-2-15.000	12.0-18.0	20	18	0.80	1.00	0.4	5	1.50:1	1.55:1	1.30:1	1.40:1

Power Divider/Combiners, SMA (cont.)



Selection Guide

Part No.	Freq. (GHz)	Isolation (dB)		Insertion Loss (dB)		Amplitude Balance (dB) (Max)	Phase Balance (degrees) (Max)	VSWR			
		Typ	Min	Typ	Max			Input		Output	
								Typ	Max	Typ	Max
4-Way 20 Watt DC Block Power Dividers											
DC804-2-1.500V	0.8-2.2	27	22	0.60	0.80	0.2	4	1.20:1	1.30:1	1.10:1	1.20:1
4-Way 50 Watt M-Series Power Dividers											
M4S-1.500W	0.8-2.2	25	20	0.60	0.80	0.2	4	1.35:1	1.15:1	1.25:1	1.25:1
4-Way 80 Watt H-Series Power Dividers											
H4S-0.900	0.8-1.0	25	20	0.30	0.40	0.2	2	1.20:1	1.25:1	1.10:1	1.15:1
H4S-1.500V	0.8-2.2	20	18	1.00	1.20	0.3	4	1.40:1	1.50:1	1.20:1	1.30:1
H4S-1.950	1.7-2.2	23	18	0.40	0.50	0.2	4	1.20:1	1.30:1	1.10:1	1.20:1
6-Way 20 Watt Power Dividers											
806-2-0.900	0.8-1.0	30	25	0.40	0.50	0.2	3	1.10:1	1.15:1	1.10:1	1.15:1
	0.6-1.2	22	17	0.50	0.70	0.2	3	1.40:1	1.50:1	1.25:1	1.35:1
806-2-1.400	0.8-2.0	25	20	0.60	0.80	0.2	4	1.40:1	1.50:1	1.10:1	1.20:1
806-S-1.900-M01	0.8-3.0	25	20	0.80	1.20	0.4	8	1.30:1	1.45:1	1.20:1	1.35:1
806-2-2.100	1.5-2.7	27	22	0.60	0.80	0.3	6	1.25:1	1.35:1	1.10:1	1.20:1
806-2-3.000	2.0-4.0	25	20	0.60	0.80	0.2	4	1.30:1	1.40:1	1.20:1	1.30:1
8-Way 20 Watt Power Dividers											
808-2-0.900	0.8-1.0	32	27	0.60	0.70	0.2	4	1.10:1	1.15:1	1.10:1	1.15:1
	0.6-1.2	23	18	0.80	1.20	0.2	4	1.40:1	1.50:1	1.25:1	1.35:1
808-2-1.500	0.8-2.2	27	22	0.80	1.20	0.2	6	1.20:1	1.40:1	1.10:1	1.20:1
808-S-1.900-M01	0.8-3.0	25	20	1.00	1.40	0.3	8	1.30:1	1.40:1	1.15:1	1.25:1
808-2-2.100	1.5-2.7	30	25	0.80	0.90	0.3	6	1.25:1	1.35:1	1.10:1	1.20:1
808-2-3.000	2.0-4.0	25	20	0.70	0.90	0.4	8	1.30:1	1.40:1	1.20:1	1.30:1
8-Way 50 Watt M-Series Power Dividers											
M8S-1.500W	0.8-2.2	27	22	0.80	1.20	0.2	4	1.25:1	1.35:1	1.10:1	1.20:1
9-Way 20 Watt Power Dividers											
809-2-0.900	0.8-1.0	35	30	0.70	0.80	0.3	4	1.15:1	1.20:1	1.10:1	1.15:1
	0.6-1.2	25	20	0.70	0.90	0.3	4	1.40:1	1.50:1	1.10:1	1.15:1
809-2-1.500	0.8-2.2	25	20	1.00	1.20	0.4	8	1.30:1	1.40:1	1.10:1	1.20:1
809-S-1.900-M01	0.8-3.0	25	20	1.20	1.60	0.3	10	1.25:1	1.35:1	1.10:1	1.20:1
809-2-2.100	1.5-2.7	27	22	1.00	1.20	0.3	8	1.30:1	1.40:1	1.20:1	1.30:1
809-2-3.100	2.0-4.2	25	22	0.80	1.20	0.3	8	1.30:1	1.40:1	1.15:1	1.25:1
12-Way 20 Watt Power Dividers											
812-2-1.500	0.8-2.2	30	25	1.00	1.20	0.3	8	1.30:1	1.40:1	1.15:1	1.25:1
812-S-1.900-M01	0.8-3.0	25	20	1.00	1.50	0.4	10	1.30:1	1.45:1	1.20:1	1.35:1
812-2-2.100	1.5-2.7	25	20	1.00	1.20	0.4	8	1.25:1	1.35:1	1.15:1	1.25:1
812-2-3.100	2.0-4.2	25	22	1.00	1.20	0.3	8	1.30:1	1.40:1	1.15:1	1.25:1
16-Way 20 Watt Power Dividers											
816-2-1.500	0.8-2.2	25	20	1.20	1.50	0.4	8	1.30:1	1.40:1	1.10:1	1.20:1
816-S-1.900-M01	0.8-3.0	25	20	1.50	1.60	0.5	12	1.40:1	1.50:1	1.15:1	1.25:1
816-2-2.100	1.5-2.7	27	22	1.20	1.50	0.4	8	1.30:1	1.40:1	1.10:1	1.20:1
816-2-3.100	2.0-4.2	27	22	1.30	1.70	0.4	8	1.25:1	1.35:1	1.15:1	1.25:1
16-Way 50 Watt M-Series Power Dividers											
M16S-1.500W	0.8-2.2	25	20	1.20	1.50	0.4	8	1.30:1	1.40:1	1.10:1	1.20:1

Note: The power ratings in this datasheet are nominal average power in the forward direction. DrawCom can supply more data on request that contains detailed forward and reverse power specifications.

Receiver Hybrid Splitter

Selection Guide

Part No.	No. Outputs	Freq Range (MHz)	Rx/Rx Isolation (dB)	Typical Insertion Loss (dB)	VSWR	Power rating (W)	Temp (°C)	Impedance (Ω)	Output Conns	Input Conns
06-001801	4-way	10-500	>20	6.5	1.3:1	1	-10 to +55	50	N female	SMA female
06-001401	4-way	140 - 470	>18	< 4.0	1.3:1	100	-20 to +60	50	N female	N female
06-001901	8-way	50-500	>20	< 10.5	1.3:1	1	-20 to +55	50	N female	SMA female
06-000601	8-way	50-500	>20	10	1.3:1	1	-20 to +55	50	N female	BNC Male

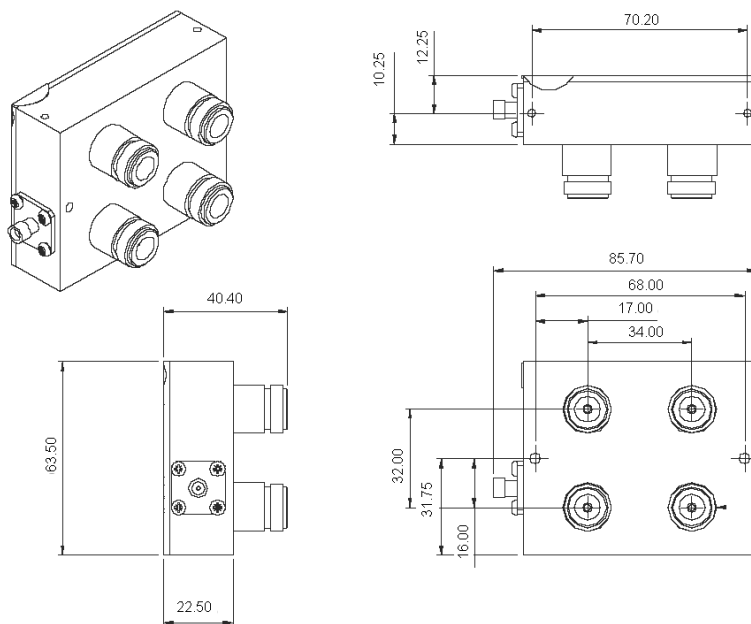

06-001801

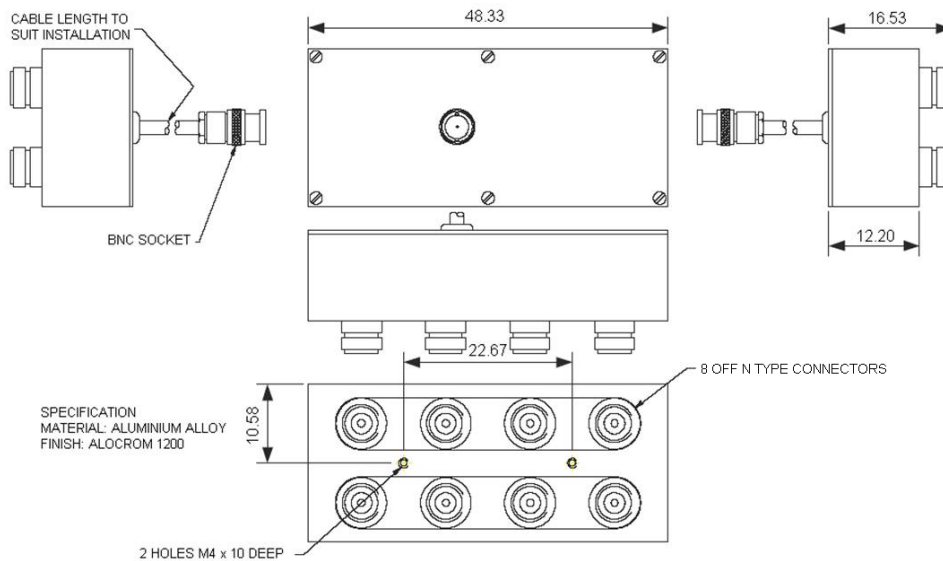

06-000601